

200mm SAN, @ 0.5%

CONCEPTUAL LINEAR PARK BY OTHERS

CLUSTER OF LARGE CONIFEROUS TREES (TYP.)

SMALL CONIFEROUS TREES (TYP.)

PLAYGROUND WITH VARIOUS PLAY EQUIPMENT STRUCTURES

AMENITY SPACE WITH INTERLOCK PAVING, SHADE UMBRELLAS AND STRUCTURES

TRAIL SYSTEM (TYP.)

SMALL DECIDUOUS TREES (TYP.)

ROW OF DECIDUOUS TREES FOR PRIVACY

REVISIONS/ SUBMISSIONS: 2023-11-10, 2023-11-13, 2023-11-15, 2023-12-15  
 JUST SAVID PROJECTS LTD. 1500 SHEPPARD AVENUE EAST, SUITE 100, SCARBOROUGH, ONTARIO M1S 1T7

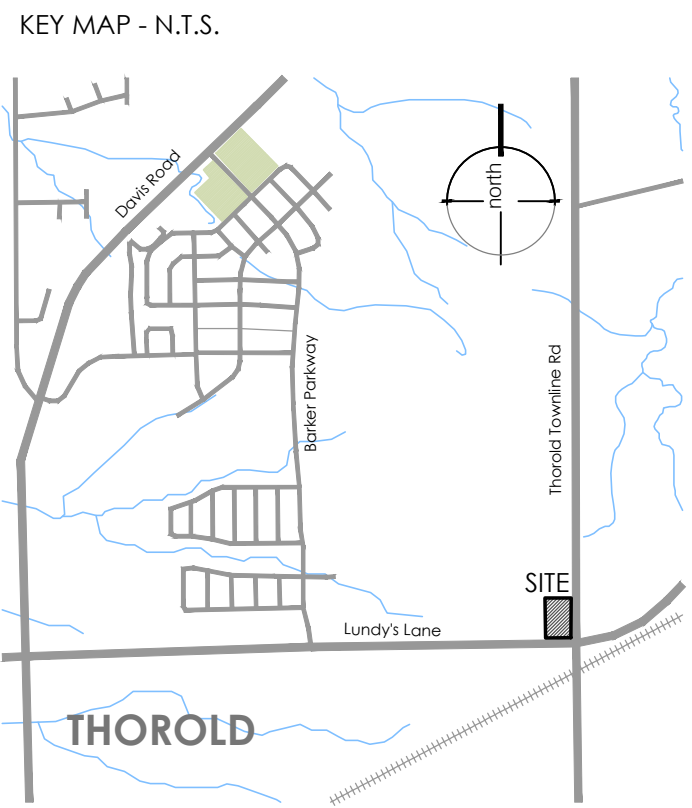

**LEGEND**

- - - property line
- proposed deciduous tree
- proposed coniferous tree
- 91.979 existing elevation
- min. 150mm topsoil, fine grade & sod
- min. 150mm topsoil, fine grade & seed
- low density - single family freeholds
- medium density - townhouse condominium
- high density - multi level condominium

**NOT FOR CONSTRUCTION**  
ISSUED FOR REVIEW & COMMENTS ONLY

**REVISIONS/ SUBMISSIONS**

#	DATE	DESCRIPTION
1	2023-11-10	Issued for review
2	2023-11-13	Issued for review
3	2023-11-15	Issued for review
4	2023-12-15	Issued for submission

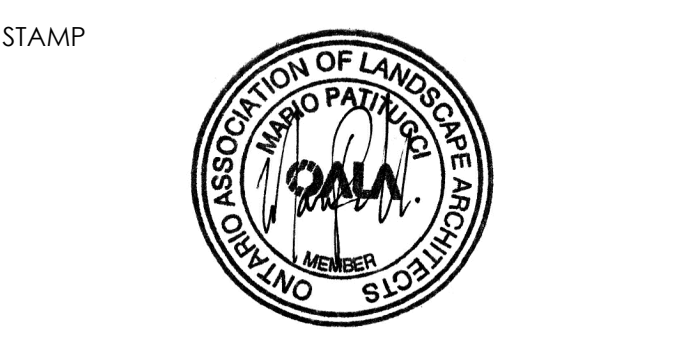

**CLIENT**  
Rudanco Hospitality Corporation  
**MUNICIPALITY**  
City of Thorold

**PROJECT**  
Lundys Lane Development  
13030 Lundys Lane  
Thorold, ON

**MUNICIPAL FILE NUMBER**

**SHEET**  
Landscape Master Plan **LC-01**

**adesso design inc.**  
landscape architecture

69 John Street South, Suite 250  
Hamilton, ON L8N 2B9  
t. 905.526.8876  
www.adessodesigninc.ca

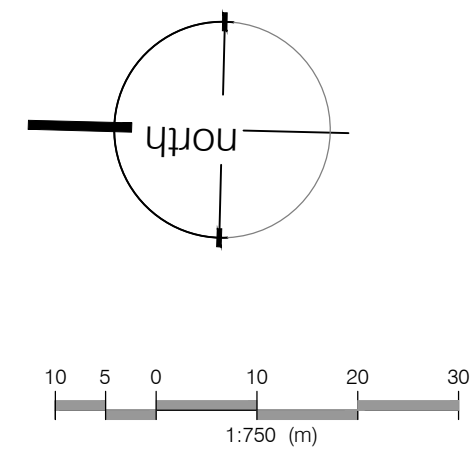

CONCEPTUAL LINEAR PARK BY OTHERS

CLUSTER OF LARGE CONIFEROUS TREES (TYP.)

TRAIL SYSTEM THROUGH PARK SPACE (TYP.)

PLAYGROUND WITH VARIOUS PLAY EQUIPMENT STRUCTURES

AMENITY SPACE WITH INTERLOCK PAVING, SHADE UMBRELLAS, AND STRUCTURES

TRAIL SYSTEM (TYP.)

SMALL DECIDUOUS TREES (TYP.)

ROW OF DECIDUOUS TREES FOR PRIVACY

- LANDSCAPE NOTES:**
- All work to be carried out in accordance with by-laws and codes having jurisdiction over site location.
  - Complete all work to the satisfaction of the Landscape Architect.
  - Report any changes, discrepancies or substitutions to the Landscape Architect for review. Obtain approval from the Landscape Architect before proceeding.
  - It is the contractor's responsibility to determine existing service locations.
  - Exact locations of plant material will be determined by placement of site services such as hydro vaults, meters, utilities, roof rain water leaders, driveways, light standards, etc.
  - All plant material locations to be staked or marked out and approved by Landscape Architect prior to installation.
  - Supply all plant material in accordance with the Canadian Standards for Nursery Stock (8th ed.).
  - Install plant material according to details shown.
  - Supply and place mulch in accordance with Canadian Landscape Standard (Section 10, Mulching). Disturbed soil areas around trees and shrubs are to be covered with shredded conifer bark mulch such as 'Cedar Bark Mulch' by All Treat Farms or 'Classic Cedar Mulch' by Gro-Bark, or approved equivalent. Alternative mulches must be approved by the Landscape Architect.
  - Contractor to utilize layout dimensions where provided
  - Provide planting bed area as noted on the drawing or to accommodate mature size of plant material.
  - All support systems must be removed by the contractor at time of final acceptance. No extras will be paid to complete this work
  - Supply and place topsoil in accordance with Canadian Landscape Standard (Section 4, Grading & Drainage and Section 6, Growing Medium) to a minimum depth of 150mm unless otherwise specified.
  - Supply and place sod in accordance with Canadian Landscape Standard (Section 7, Lawns & Grass and Section 8, Turfgrass Sod) unless otherwise specified.
  - Supply and place seed in accordance with Canadian Landscape Standard (Section 4, Grading & Drainage and Section 6, Growing Medium) unless otherwise specified. All 5:1 or greater slopes to be seeded with facelift. Contractor to provide necessary erosion control protection as required to ensure soil stabilization and proper seed germination.
  - All dimensions in meters unless otherwise noted.
  - If discrepancies arise between plant material count shown on drawing and plant list, the drawing shall be considered correct.
  - Contractor to provide minimum one (1) year warranty (including trees on municipal property) from date accepted on all work unless otherwise specified.
  - Any site plan or grading and servicing shown is for information only. Refer to approved drawings.
  - Not for construction unless stamped, signed and dated by Landscape Architect.
  - Drawings not to be reproduced without written consent from Landscape Architect.
  - Approval of landscape plan to be obtained from municipality.
  - All plant material to be planted a minimum of 1.0m from any swales or ditches.
  - For grading and servicing information refer to the consulting Engineer's drawings.
  - For lighting information and power distribution refer to the electrical consultant's drawings.

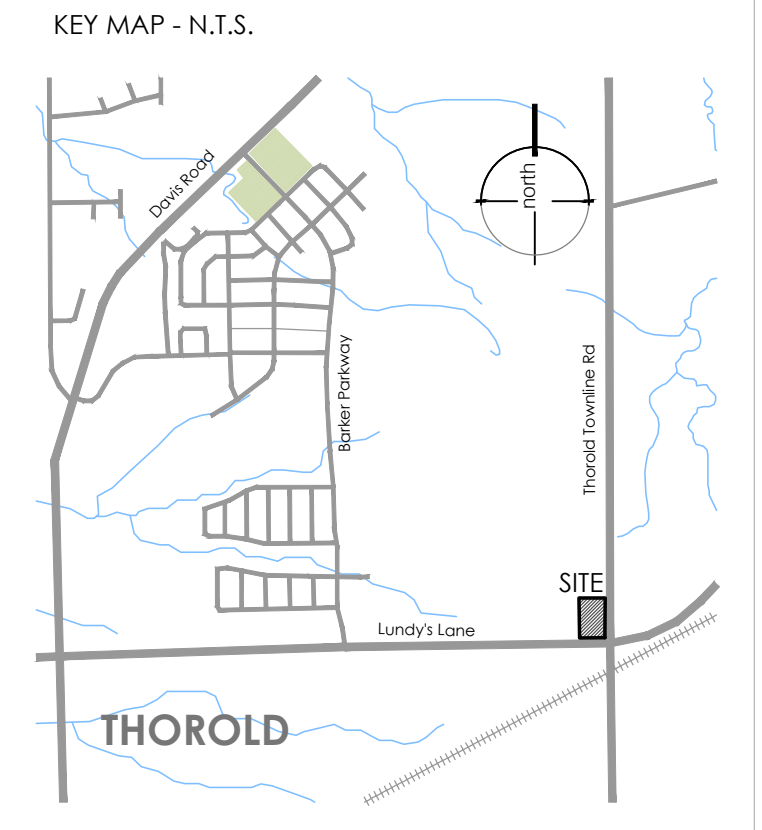

**LEGEND**

- property line
- proposed deciduous tree
- proposed coniferous tree
- 91.979 existing elevation
- min. 150mm topsoil, fine grade & sod
- min. 150mm topsoil, fine grade & seed
- low density - single family freeholds
- medium density - townhouse condominium
- high density - multi level condominium



ROW OF TREES ALONG ROAD AND SIDEWALK



SUBDIVISION WITH TREES LAYOUT

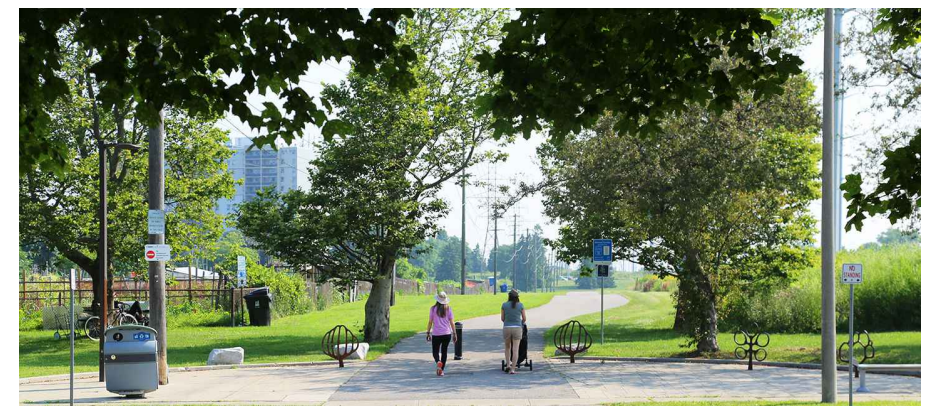

WALKING TRAIL SYSTEM



COMMUNITY COVERED STRUCTURE AND PARK



PLAYGROUND WITH SHADE STRUCTURE

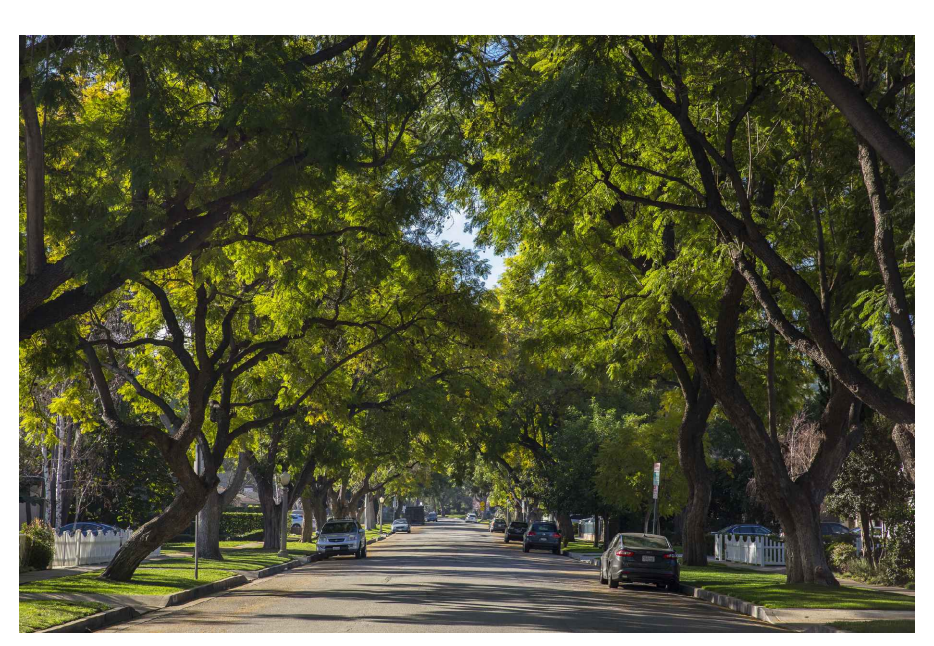

STREET TREES

**NOT FOR CONSTRUCTION**  
ISSUED FOR REVIEW & COMMENTS ONLY

**REVISIONS/ SUBMISSIONS**

#	DATE	DESCRIPTION
1	2023-11-10	Issued for review
2	2023-11-13	Issued for review
3	2023-11-15	Issued for review
4	2023-12-15	Issued for submission



**CLIENT**  
Rudanco Hospitality Corporation  
**MUNICIPALITY**  
City of Thorold

**PROJECT**  
Lundys Lane Development  
13030 Lundys Lane  
Thorold, ON  
**MUNICIPAL FILE NUMBER**

**SHEET**  
Landscape Master Plan **LC-02**

**adesso design inc.**  
landscape architecture

69 John Street South, Suite 250  
Hamilton, ON L8N 2B9  
t. 905.526.8876  
www.adessodesigninc.ca

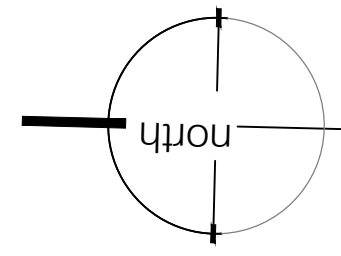

TOWNLINE ROAD

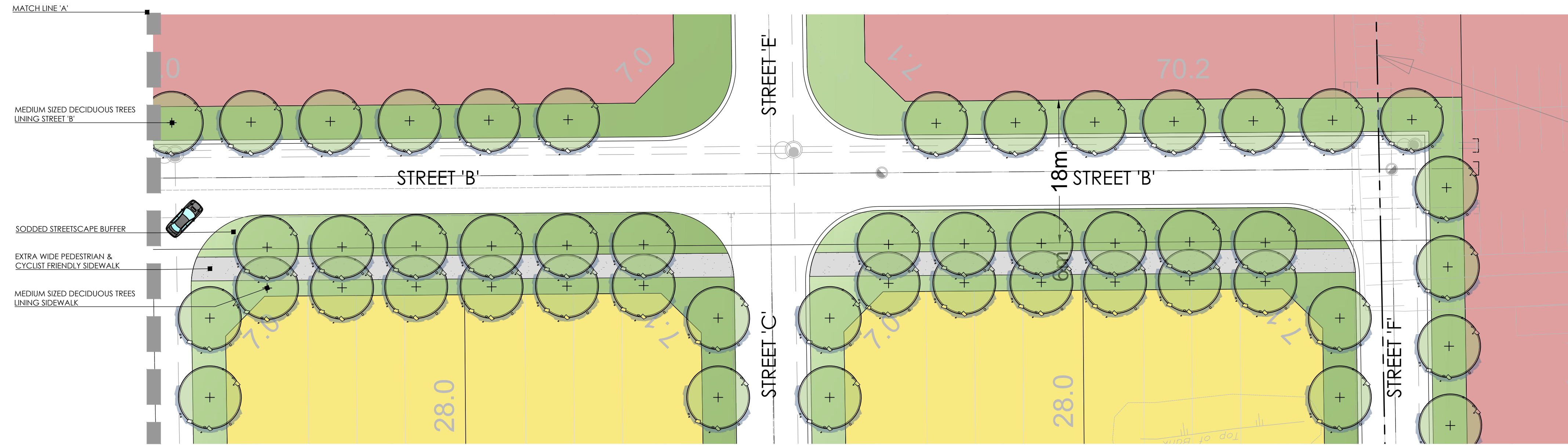

ENLARGEMENT - STREET 'B' SOUTHERN STREETSCAPE  
SCALE 1:300



ENLARGEMENT - STREET 'B' NORTHERN STREETSCAPE  
SCALE 1:300

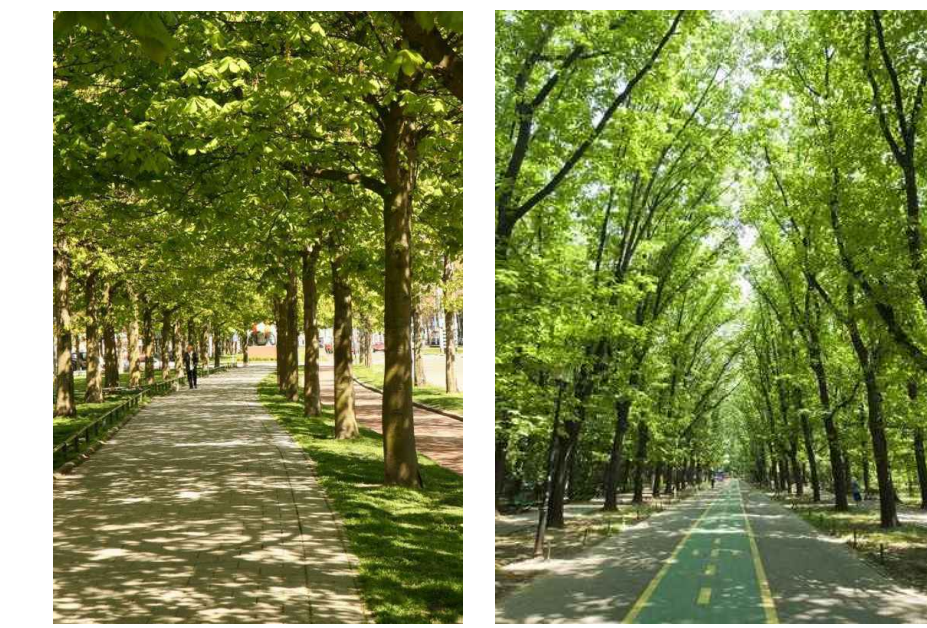

EXTRA WIDE SIDEWALK WITH DOUBLE ROW OF STREET TREES



WALKING TRAIL SYSTEM



PEDESTRIAN AND CYCLIST FRIENDLY SIDEWALK

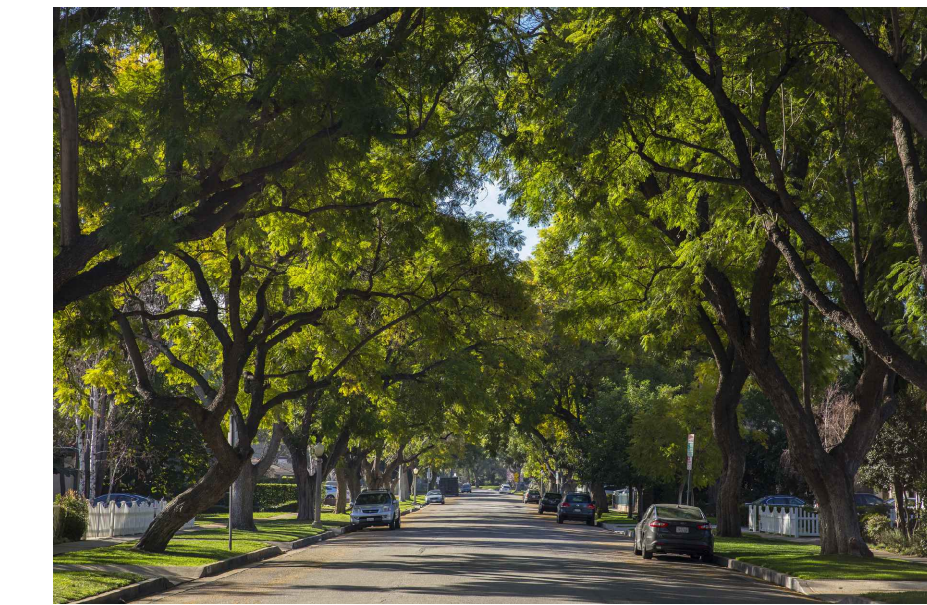

STREET TREES

LANDSCAPE NOTES:

- All work to be carried out in accordance with by-laws and codes having jurisdiction over site location.
- Complete all work to the satisfaction of the Landscape Architect.
- Report any changes, discrepancies or substitutions to the Landscape Architect for review. Obtain approval from the Landscape Architect before proceeding.
- It is the contractor's responsibility to determine existing service locations.
- Exact locations of plant material will be determined by placement of site services such as hydro vaults, meters, utilities roof rain water leaders, driveways, light standards, etc.
- All plant material locations to be staked or marked out and approved by Landscape Architect prior to installation.
- Supply all plant material in accordance with the Canadian Standards for Nursery Stock (8th ed.).
- Install plant material according to details shown.
- Supply and place mulch in accordance with Canadian Landscape Standard (Section 10, Mulching). Disturbed soil areas around trees and shrubs are to be covered with shredded conifer bark mulch such as 'Cedar Bark Mulch' by All Treat Farms or 'Classic Cedar Mulch' by Gro-Bark, or approved equivalent. Alternative mulches must be approved by the Landscape Architect.
- Contractor to utilize layout dimensions where provided.
- Provide planting bed area as noted on the drawing or to accommodate mature size of plant material.
- All support systems must be removed by the contractor at time of final acceptance. No extras will be paid to complete this work.
- Supply and place topsoil in accordance with Canadian Landscape Standard (Section 4, Grading & Drainage and Section 6, Growing Medium) to a minimum depth of 150mm unless otherwise specified.
- Supply and place sod in accordance with Canadian Landscape Standard (Section 7, Lawns & Grass and Section 8, Turfgrass Sod) unless otherwise specified.
- Supply and place seed in accordance with Canadian Landscape Standard (Section 4, Grading & Drainage and Section 6, Growing Medium) unless otherwise specified. All 5:1 or greater slopes to be seeded with topsoil. Contractor to provide necessary erosion control protection as required to ensure soil stabilization and proper seed germination.
- All dimensions in meters unless otherwise noted.
- If discrepancies arise between plant material count shown on drawing and plant list, the drawing shall be considered correct.
- Contractor to provide minimum one (1) year warranty (including trees on municipal property) from date accepted on all work unless otherwise specified.
- Any site plan or grading and servicing shown is for information only. Refer to approved drawings.
- Not for construction unless stamped, signed and dated by Landscape Architect.
- Drawings not to be reproduced without written consent from Landscape Architect.
- Approval of landscape plan to be obtained from municipality.
- All plant material to be planted a minimum of 1.0m from any swales or ditches.
- For grading and servicing information refer to the consulting Engineer's drawings.
- For lighting information and power distribution refer to the electrical consultant's drawings.

KEY MAP - N.T.S.

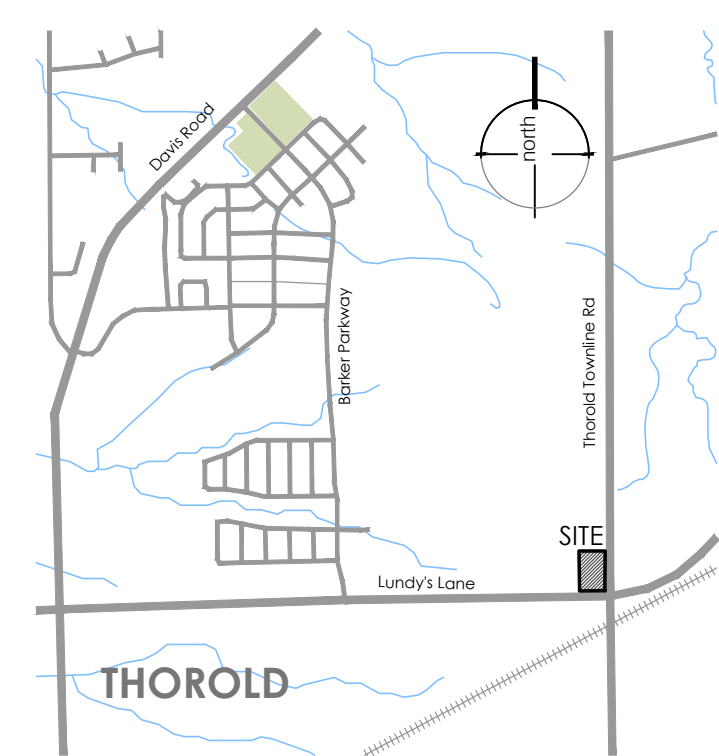

LEGEND

- property line
- proposed deciduous tree
- proposed coniferous tree
- 91.979 existing elevation
- min. 150mm topsoil, fine grade & sod
- min. 150mm topsoil, fine grade & seed
- low density - single family freeholds
- medium density - townhouse condominium
- high density - multi level condominium

NOT FOR CONSTRUCTION  
ISSUED FOR REVIEW & COMMENTS ONLY

REVISIONS/ SUBMISSIONS

#	DATE	DESCRIPTION
1	2023-11-10	Issued for review
2	2023-11-13	Issued for review
3	2023-11-15	Issued for review
4	2023-12-15	Issued for submission

STAMP

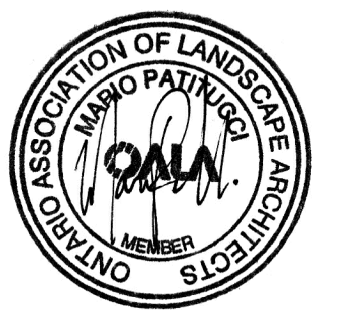

CLIENT  
Rudanco Hospitality Corporation  
MUNICIPALITY  
City of Thorold

PROJECT  
Lundy's Lane Development  
13030 Lundy's Lane  
Thorold, ON

MUNICIPAL FILE NUMBER

SHEET  
Landscape Master Plan  
LC-03

adesso design inc.  
landscape architecture

69 John Street South, Suite 250  
Hamilton, ON L8N 2B9  
t. 905.526.8876  
www.adessodesigninc.ca